

Scan the QR code to verify that you have the latest instructions or visit vaultenclosures.com/instructions

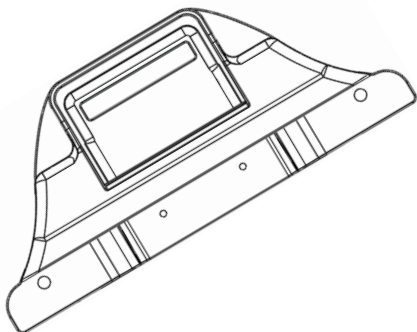

PARTS INCLUDED

PRO-C2X Bracket

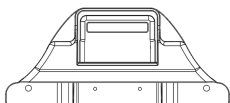

(1)

10-32x3/8
Flat Head

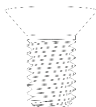

(2)

6-32x1/8
Pan Head



(2)

MSR L-bracket

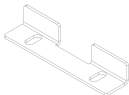

(1)

Charging Cable

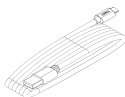

(1)

Dual Sided
Adhesive Strip



(2)

1. Remove the red film from the dual sided adhesive on the PRO-C2X and insert the card reader into the PRO-C2X bracket.

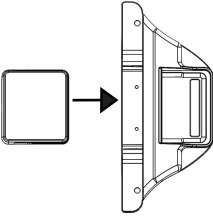

2. Install the L-Bracket to secure the reader in place using the 6-32x1/8 Pan Head Screws and plug the Charging Cable into the card reader.

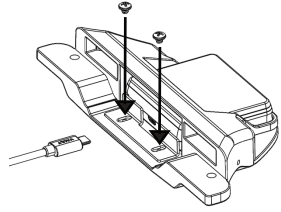

3. Connect the iOS cable to the iPad. Ensure your iPad is already installed in your enclosure.

4. With your enclosure face down, align the bracket to the corresponding holes on the enclosure. Install using the 10-32x3/8 Flat Head Screws.

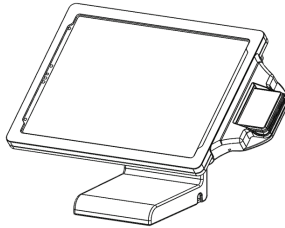
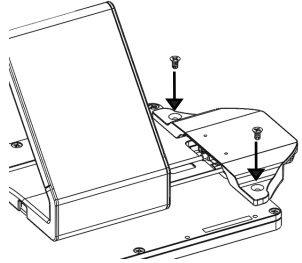
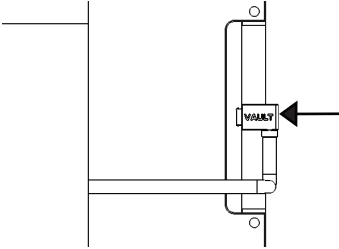

REFER TO TABLET ENCLOSURE INSTRUCTIONS
TO FINISH YOUR SOLUTIONS ASSEMBLY

