

Scan the QR code to verify that you have the latest instructions or visit vaultenclosures.com/instructions

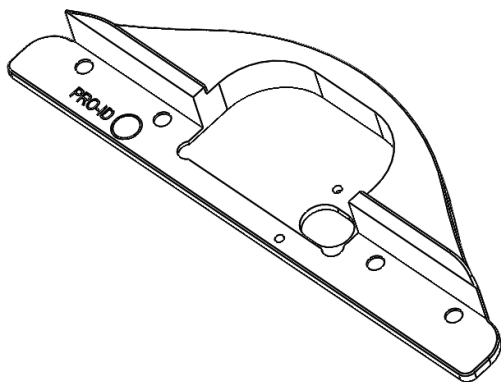

PARTS INCLUDED

iDynamo 5 Bracket



(1)

Wire Management

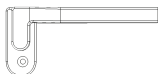

(1)

10-32x3/8
Flat Head



(4)

1. Insert the card reader into the lightning port.

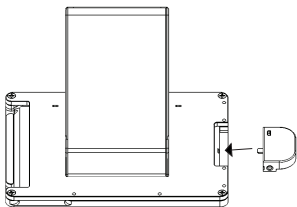

2. Lay card reader bracket down over top of card reader and secure by using the 6-32x1/8

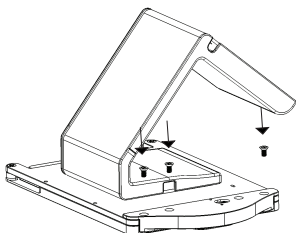

3. Install the power cable.

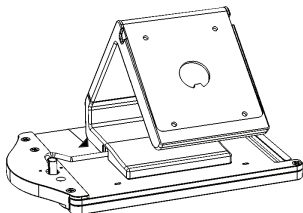

4. Install Wire Management by using the (1) 10-32x3/8 screw.

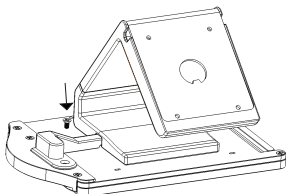

REFER TO TABLET ENCLOSURE INSTRUCTIONS
TO FINISH YOUR SOLUTIONS ASSEMBLY

