

Scan the QR code to verify that you have the latest instructions or visit vaultenclosures.com/instructions



PARTS INCLUDED

a



10-32X3/8
Pan Head
(3)

b



10-32X1/2
Flat Head
(6)

c



10-32x1/2
Pan Head
(4)

d



6-32x3/8
Flat Head
(3)

e

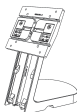

Base
(1)

f



Cable Cover
(1)

g



Duraco Adhesive
Large Foot
(2)

h



Duraco Adhesive
Small Foot
(2)

1. REMOVE CABLE COVER

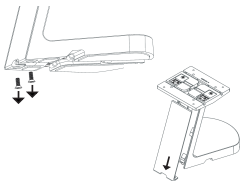

2. ROUTE CABLE

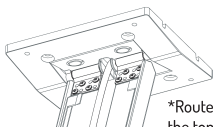

*Route your cable through the top of the mounting plate if using an enclosure with internal cable management.

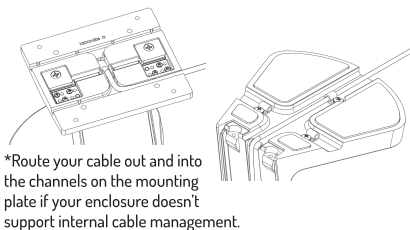

*Route your cable out and into the channels on the mounting plate if your enclosure doesn't support internal cable management.

3. REINSTALL THE CABLE COVER

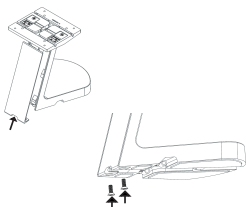

4. DETERMINE WHICH SET OF HOLES YOU WILL HAVE FOR INSTALLATION

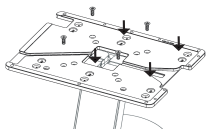
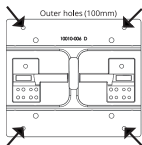

To mount your backplate with no screws showing from the outside, use the included 10-32x1/2 (b) Flat Head screws and mount your backplate from the inside of the backplate

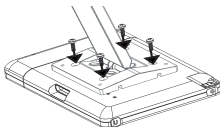
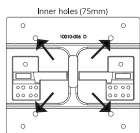

For assembly of Connect enclosure and base, use the included 10-32x1/2 (c) Pan Head screws and the inner set of holes to mount your enclosure to the base from the backside

SURFACE MOUNTING OPTIONS

Standard

For a non-permanent mounting solution, peel off the film from the bottom of the rubber feet on the base.

Semi-Permanent

For a semi-permanent mounting solution, use the (4) duraco pads included with your base. Peel off one side of the film and stick it to the matching rubber foot on the base. Let the adhesive **cure onto the base for 3 hours** before peeling off the other side and sticking it to your desired surface. Once you have stuck the base down to a surface, let it sit for another **12 hours** with **NO** interaction before use. To remove duraco, take a piece of filament such as fishing line or dental floss and run underneath the base in a sawing motion to cut the adhesive.

REFER TO TABLET ENCLOSURE INSTRUCTIONS TO FINISH YOUR SOLUTIONS ASSEMBLY

