

PARTS INCLUDED

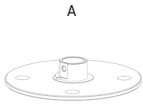

Rotation Base
(1)



Rotation Base Bushing
(1)

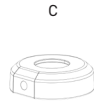

Rotation Base Cap
(1)

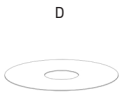

Protective Disk
(1)

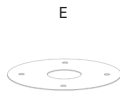

Dual Sided Adhesive
(1)



10-32 x 3/8 Panhead
Screw (1)

PREASSEMBLY

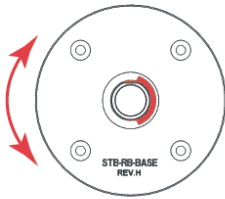

Mount the Rotation Base (A) as shown for clockwise 180° rotation

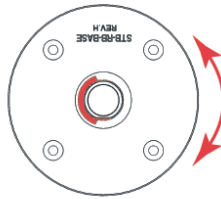

Mount the Rotation Base (B) as shown for counter clockwise 180° rotation

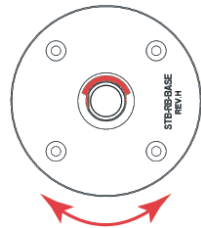

Mount the Rotation Base (B) as shown for -90° to 90° rotation

For permanent mounting, use (4) #10-32 screws (NOT INCLUDED)

Ensure the screws do not extend above the base

For semipermanent mounting, peel the cover off the Dual Sided Adhesive (E) and the bottom of the Rotation Base and apply to the desired area. Allow 24 hours for the adhesive to fully adhere.

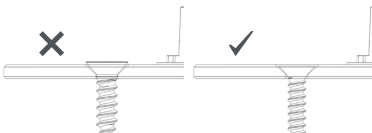

1. Place the Protective Disk (D) on top of the Rotation Base (A)

2. Set the Stability Base on top of the Rotation Base center post as shown

3. Place the Bushing (B) onto the center post

4. Place the Cap (C) on top of the post and secure with the 10-32 x 3/8 set screw

5. Apply Double Sided Adhesive (E) to the bottom of the Rotation Base. Remove the yellow film and apply to the base ensuring the holes are aligned

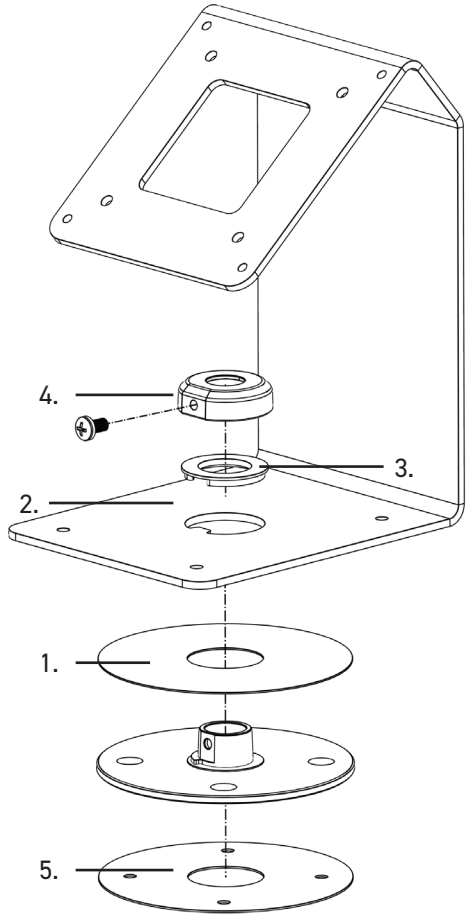

REFER TO TABLET ENCLOSURE INSTRUCTIONS TO
FINISH YOUR SOLUTIONS ASSEMBLY

